

# ML6300FB-SC Specifications

# OKI



## The compact, 24-pin dot matrix printer, with Skew Correct

### A 24-pin dot matrix printer with essential credentials for front desk work, offering both reliability and assistance.

The ML6300FB-SC is built for task critical situations, such as at the front desk of banks, travel agents, stations or surgeries. For printing slips, tickets, receipts, forms, multipart documents, both pre-cut and tractor fed, the ML6300FB-SC keeps transactions smooth and customers happy.

### OKI's commitment to customers

The OKI brand is one of proven reliability and value. We provide printers that increase our customers' long-term business performance without impacting their budget.

With almost half a century of experience in the impact printer industry, with OKI you are guaranteed a best-in-class, low cost, reliable and easy to use printer. And, for total peace of mind just register your product and take advantage of our extended three-year warranty at no extra cost.

### Skew correction equals cost reduction

Skew correction reduces mistakes by human error, saving paper cost and operation time. As operation is so easy, virtually no training is required for the user.

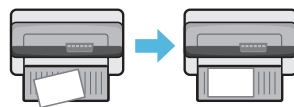

Automatically corrects paper skew

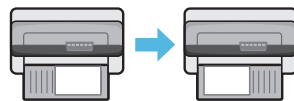

Paper can be loaded from any position for the same printing result

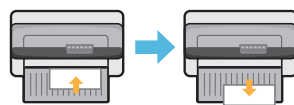

Printer can sense paper width and reject it if incorrect

### Compact, quick and highly capable

- Small footprint allows printer to be close to hand
- Print speeds of up to 450 characters per second (cps) allow for faster transactions, improving customer satisfaction
- Flat bed design provides broad media handling capability, including heavier media weight and multi-part paper handling (1 original + 5 copies) for greater efficiency and convenience

### Higher uptime. Lower costs

- Original ribbons have a high ribbon life meaning fewer changes, minimal interruption to production and lower running costs
- 'Clean hands' ribbon changing ensures no delay, mess or hassle when fitting a new ribbon
- Three-year warranty as standard (product registration required)

Variant available:  
ML6300FB-SC



# ML6300FB-SC - Dot Matrix Printer

Printer	
Number of pins	24
Columns	106 (10cpi); 212 (maximum in compression mode)
Character pitch	10/12/15/17.1/20 pitch and proportional
Graphics resolution	Up to 360 x 360dpi
Print speed	Utility: 450cps (15cpi); High Speed Draft: 400cps (10cpi); Utility: 300cps (10cpi); Letter Quality: 100cps (10cpi)
Interface and Emulations	
Interfaces	Centronics parallel interface, USB 2.0 (full speed)
Optional Interfaces	Serial RS 232C, OKILAN 7120e Network Card
Emulations	Epson LQ, IBM PPR, IBM AGM
Typeface & font	HSD, Utility, Courier, Roman, Swiss, Swiss Bold, Prestige, Gothic, Orator, OCR-A, OCR-B
Typestyle	Emphasised, Enhanced, Double Width, Double Height, Italics, Outline, Shadow, Superscript, Subscript, Underline, Overscore
Paper Handling	
Continuous paper (width)	76.2 - 304.8mm
Continuous paper (length)	76.2 - 355.6mm
Cut sheet paper (width)	90 - 304.8mm (manual) , 148 - 304.8mm (skew correction)
Cut sheet paper (length)	55 - 420mm
First printable line (from top of page)	Continuous (multi-parts): 2.12mm; Cut sheet (single sheet): 2.12mm
Copy capability	Up to 1 original + 5 copies
Cut-sheet paper weight	Single part: 52 to 209gsm; Multi-part: 40gsm
Continuous paper weight	Single part: 52 to 128gsm; Multi-part: 40gsm
Cut-sheet paper thickness	0.36mm
Continuous paper thickness	0.36mm
Paper feeding	Push tractor, Friction feed

General Features	
Input buffer	64Kbytes
Power supply	Single phase 220 to 240VAC, +/- 10%, frequency 50/60Hz, +/- 2%
Power consumption	Rolling ASCII, LQ Courier: 60W; Sleep mode (no options attached): Max 15W
Noise level	58dB(A)
Dimensions (HxWxD)	210 x 425 x 255mm
Weight	7.5kg approx
Print Head life	200 million characters (average) in 10cpi Utility mode at normal 25% duty cycle, 35% page density
Reliability	MTBF: 12,000 hours (duty cycle 25%, page density 35%)
Warranty	3 years extended warranty upon registration within 30 days of purchase
Product order numbers	01265001

Accessories (Order Numbers)	
Serial RS 232C	09002351
OKILAN 7120e Network Card	01144601

Consumables (Order Number)	
Ribbon (4 million characters)	43503601

**Consumables Information:** Only use genuine OKI Printing Solutions Original consumables to ensure the best quality and performance from your hardware. Non OKI Printing Solutions Original products may damage your printer's performance and invalidate your warranty.



## Simply Unique - 3 Year Warranty

Our devices are manufactured to the highest standards of quality and technology, which has been confirmed by independent tests. We are so convinced of the high quality of our products that we are offering you an extension of the standard warranty period to 3 years – for free! Simply register your product within 30 days of purchase to be eligible for our unique all inclusive offer. Fully covered by OKI! For further information please visit: [www.okiprintingsolutions.co.uk/warranty](http://www.okiprintingsolutions.co.uk/warranty) Without registration, the standard pan-European 1 year warranty applies.

**WARNING!** This product complies with EN55022 Class B. However when fitted with the optional network interface card or optional cut sheet feeder, compliance to EN55022 is Class A. In a domestic environment this configuration may cause radio interference, in which case the user may be required to take adequate control measures.

**OKI EUROPE LTD**  
Blays House, Wick Road,  
Egham Surrey, TW20 0HJ.  
UK  
T +44 (0)20 8219 2190  
F +44 (0)20 8219 2199  
[WWW.OKI.COM/EU](http://WWW.OKI.COM/EU)

# OKI

Open up your dreams